

How to install Honeycomb Blinds



What you'll need:



Measuring
tape



Level



Box Knife



Drill



P2 Phillips Screw
Tip, 100mm Long



#6 Countersink
Drill Bit

Before Beginning

Check the order form to ensure you have all the parts required for the type of installation you are undertaking

Make sure the 'Item #' box labels match if multiple panels will be used. This application will have a separate frame box or boxes to match with the 'Item #'



Honeycomb Corded & Corded TDBU steps

1

Bracket Installation

Measure 3" (76.2 mm) from both ends of the head rail. Mark the bracket location on the mounting surface

Proper alignment of brackets will make installation easier

NOTE: Space the brackets evenly.

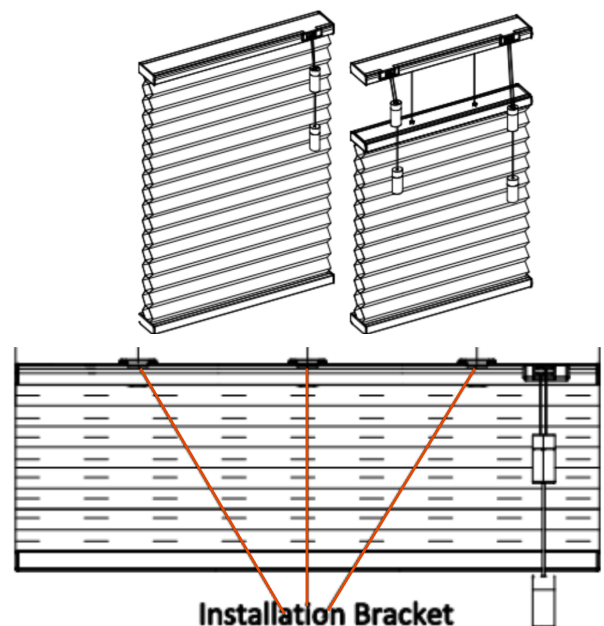

Please see next page for 'Remainder steps'

A. for 3/8" Double cell, 9/16" Single cell & 3/4" Single cell

Inside Mount:

Allocate a min. distance of 3/16" from wall to the front of brackets. Use two 1 1/4" mounting screws to secure brackets. Use wall anchors for drywall or plaster wall. (Align the front of brackets flush with wall if only lock the back hole in the brackets.)

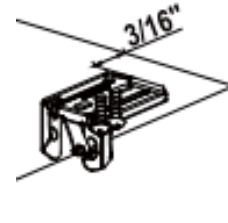

Outside Mount:

Allocate a min. distance of 5/16" from the end of brackets to the top window frame. Use two 1 1/4" mounting screws to secure brackets. Use wall anchors for drywall or plaster wall.

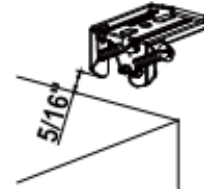

B. for 3/8" Single cell

Inside Mount:

Allocate a min. distance of 5/16" from the edge of the wall to the front of brackets. Use two 1 1/4" mounting screws to secure brackets.

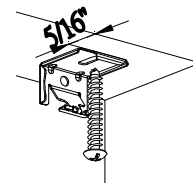

Outside Mount:

Allocate a minimum distance of 3/16" from the end of brackets to the top window frame. Use two 1 1/4" mounting screws to attach each bracket.

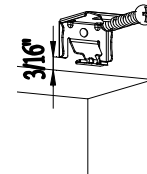

NOTE: For shallow mounting, using flat head screw to secure the bracket in 45

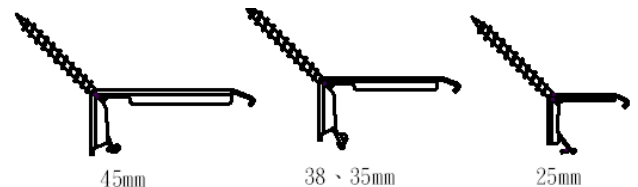

2

Shade Installation

Position the shade so that the front is facing you.

Insert the rail with an angle facing the window; hooking up with the bracket front side, and then push it upward to snap into the bracket.

For proper installation, start with attaching the front rail to the bracket.

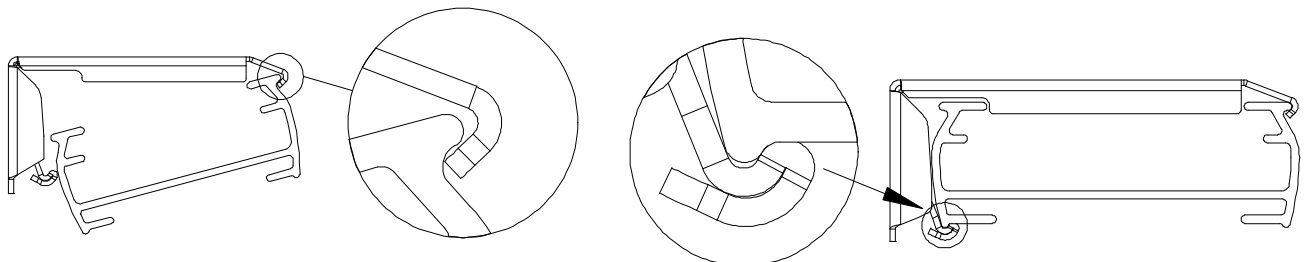

Please see next page for 'Remainder steps'

3

How to Install Hold Down Brackets

Use M3x15mm screw to secure the magnet catch at the below location. Make sure the magnet catch align with the pre-installed magnet on shade bottom rail.



4

Shade Operation

For Corded TDBU & Day & Night: when lowering the shade, pull the left cord to lower the bottom rail first and then pull the right cord to lower the middle rail. When raising the shade, reverse operation. Raise the middle rail first and then bottom rail.

5

Cord Cleat

Install the cord cleat on the wall. Wrap the operating cords around the cord cleat for child safety. Always use the cord cleat to keep cords out of the reach of children. The cleat should be installed more than 64" (1.6m) from the door.

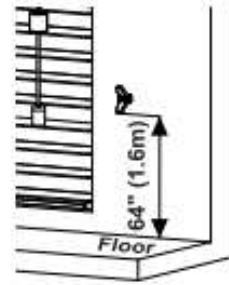

Remove the Shade

- For Corded, Fully raise the shade
- For Corded TDBU & Day & Night, Lower the mid rail
- Insert screwdriver into the gap between the back of the rail and the bracket. Gently maneuver the screwdriver toward yourself to pry the bracket.



How to Reassemble Ellipse Safety for 3/8" S Cord Connector

Our Shade comes equipped with an Ellipse Safety Cord Connector that prevents child strangulation. If the device comes apart, please refer to below steps:

1. Open the Ellipse Safety Cord Connector entirely.
2. Align all cords and slide them into the slot of Ellipse Safety Cord Connector;
3. Close the Ellipse Safety Cord Connector;
4. Pull the tassel cords and make sure it is closed tightly

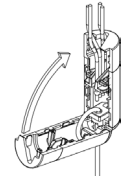
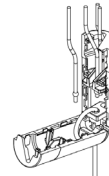
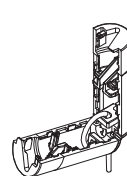

Safety Warning

Warning! Children can become entangled and strangle in window shade cords. Keep all cords out of reach from children. Move cribs and other furniture away from window coverings with cords. The following

devices are recommended:

- Cord cleat (included) • Clip/Clamp
- Tie the cord to itself • Use any tie-down device



Please see next page for 'Honeycomb for Skylight steps'

Honeycomb for Skylight steps

Honeycomb Shades SmartFit™ System for sloped windows

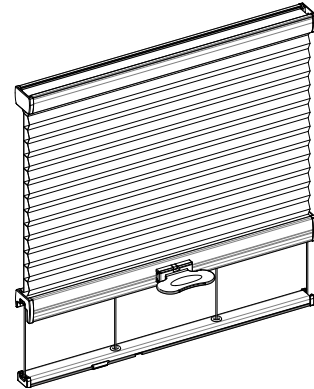

1 Bracket Installation Top Rail

Install bracket on each end of the top rail. When there are more than two brackets, the distance between brackets should be equal.

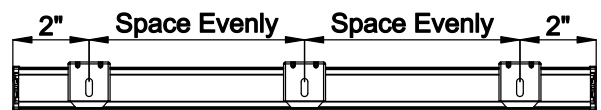

Bottom Rail

Two brackets on each end. If there are five brackets, the fifth bracket should be positioned in the middle of the rail.

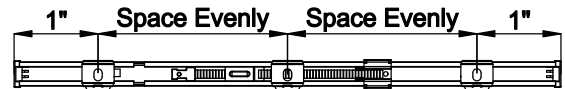

2 Inside Mount

The distance between top rail bracket screw hole to the front of the frame should be at least 5/8" from the wall. As for bottom rail, min. of 1/2" from bracket screw hole to the front of the frame and 1" from the wall.

Mount H/R brackets with 1 1/4" screws and B/R brackets with M3.5×25mm screws aligned horizontally.

Use wall anchors for drywall or plaster wall.

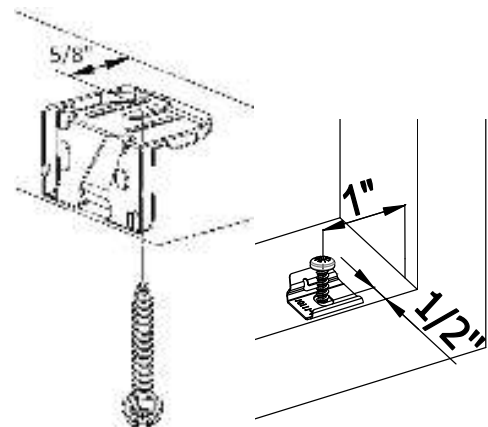

Top

Bottom

NOTE: Do not over tighten the screw.

Outside Mount

Min. distance between top rail bracket screw hole to the top edge of the frame should be at least 5/8" to the shade edge. Mount brackets with 2pcs of 1 1/4" screws aligned horizontally.

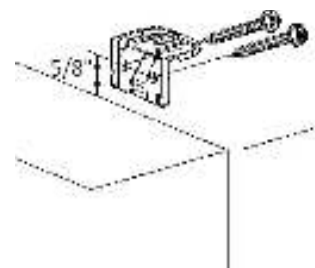

NOTE: Do not over tighten the screw.



Please see next page for 'Remainder steps'

The distance between bottom rail L bracket screw hole to the bottom edge of the frame should be at least 1 1/8" and 1" from the shade edge. Mount L brackets with 2pcs M3.5×25mm screw. Cover the brackets and secure with M3x3.6 screw.

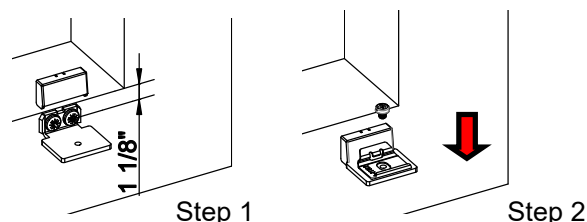

NOTE: Do not over tighten the screw.

3 Install the Shade

Position the shade so that the front is facing you.
-Insert the rail with an angle facing the window; hook from the bracket front and push upward to snap it in.

NOTE: For proper installation, start with attaching the front rail to the bracket

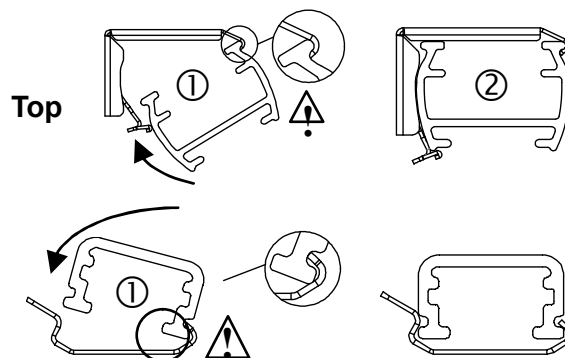

4 Handle Installation

Slide the handle onto the plastic piece that is pre-attached to the rails.

Step1



Step2



5 Steel Wire

Adjust the Steel Wire After the installation, tighten the steel wire by sliding the regulator towards the direction as shown on label in **Drawing 1**.

For easier tightening the steel wire, it is suggested to use a pliers to pull the steel wire towards the bottom rail, and then adjust the regulator pin to tighten the steel wire. Put a cloth between the pliers and steel wire in case the steel wire breaks.

Label



Drawing 1

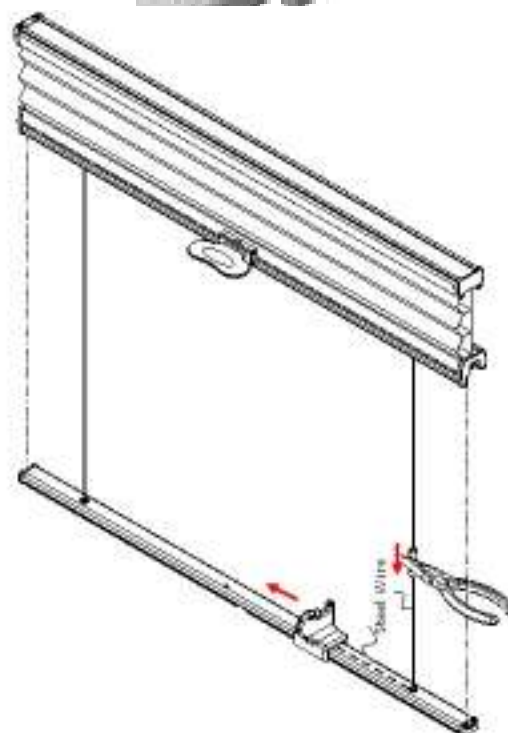

Please see next page for 'Remainder steps'

To loosen the steel wire, place the regulator pin on the bottom rail and press down as shown in **Drawing 2**.

Drawing 2

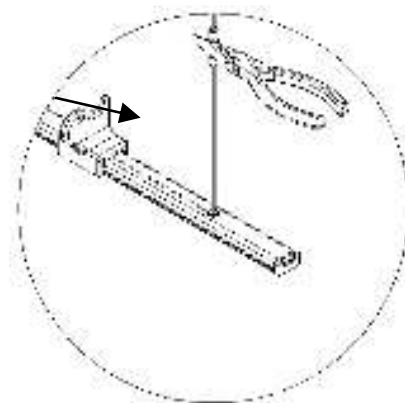

Remove the Shade

Fully raise the shade.

Insert screwdriver into the gap between the back of the rail and the bracket. Gently maneuver the screwdriver toward yourself to pry the bracket.

